

1 Job counter

1.1 The number of sheets menu - overview of buttons and displays

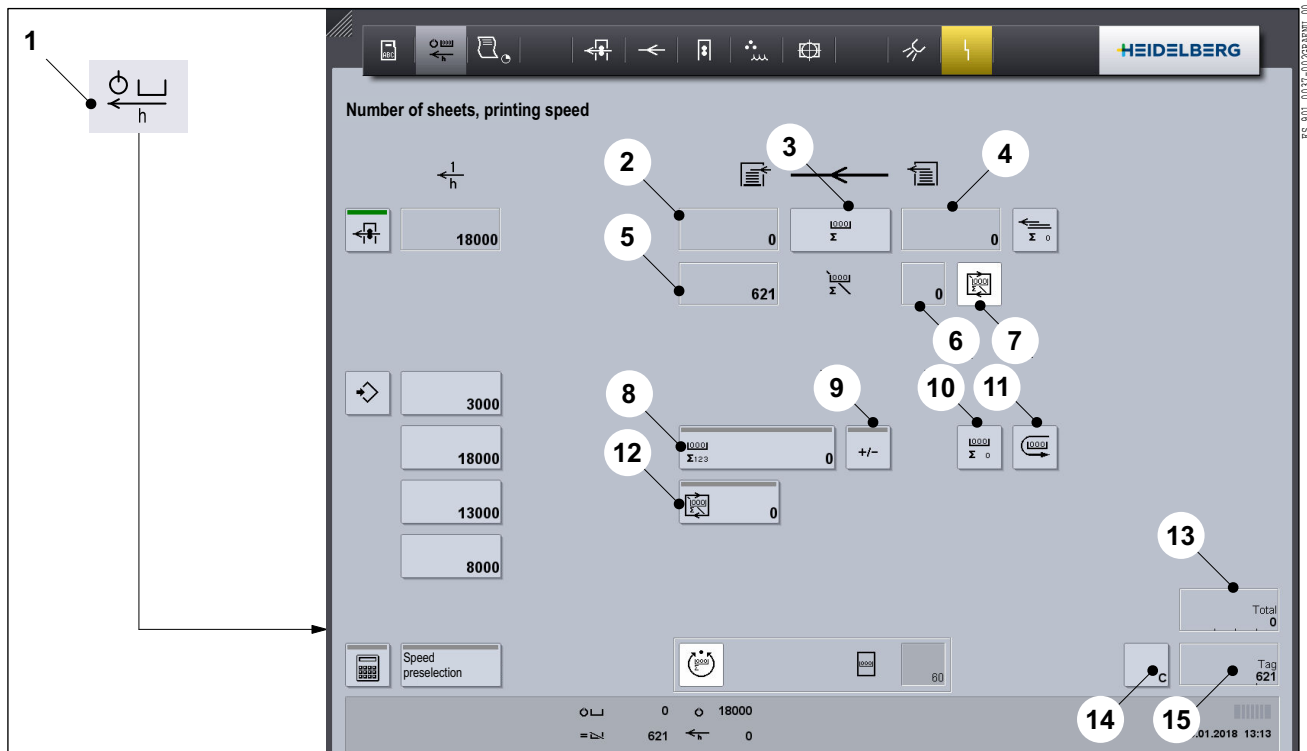

Fig. 1 Number of sheets, printing speed menu

1. Press the *Number of sheets, printing speed* button (Fig. 1/1) in the headline. The **Number of sheets, printing speed** menu appears.

The **Number of sheets, printing speed** menu contains the following displays and buttons:

- Job counter (Fig. 1/2)
Displays the printed number of sheets.
- The *Job counter* button (Fig. 1/3)
Switches the job counter on and off. When you switch on the counter, the waste-sheet counter is switched off automatically.
- Residual number of impressions counter (Fig. 1/4)
Shows the pressrun still to be printed.
- Waste-sheet counter (Fig. 1/5)
Displays the number of printed waste sheets.
- The *Makeready interval for the residual number of impressions* button (Fig. 1/6)
Displays the number of waste sheets that can still be printed.
- The *Makeready interval on/off* button (Fig. 1/7)
Switches the makeready interval counter on and off.
- The *Desired number of sheets* button (Fig. 1/8)

Opens a window with a numeric keypad. You can enter the desired number of sheets for the current print job.

- The *+/-* button (Fig. 1/9)
Opens a window with a numeric keypad. You can increase and decrease the entered desired number of sheets.
- The *Job counter zero* button (Fig. 1/10)
Resets the job counter (Fig. 1/2) to 0.
- The *Repeat desired number of sheets* button (Fig. 1/11)
Sets the previous number of impressions for the next print job.
- The *Enter makeready interval* button (Fig. 1/12)
Opens a window with a numeric keypad. You can enter the makeready interval for the current print job.
- Total sheet counter (Fig. 1/13)
Displays the total number of sheets printed on the press.
- The *Day sheet counter zero* button (Fig. 1/14)
Resets the day sheet counter (Fig. 1/15) to 0.
- Day sheet counter (Fig. 1/15)
Displays the number of sheets printed since the last resetting to 0.

1.2 Setting the number of sheets for the current print job

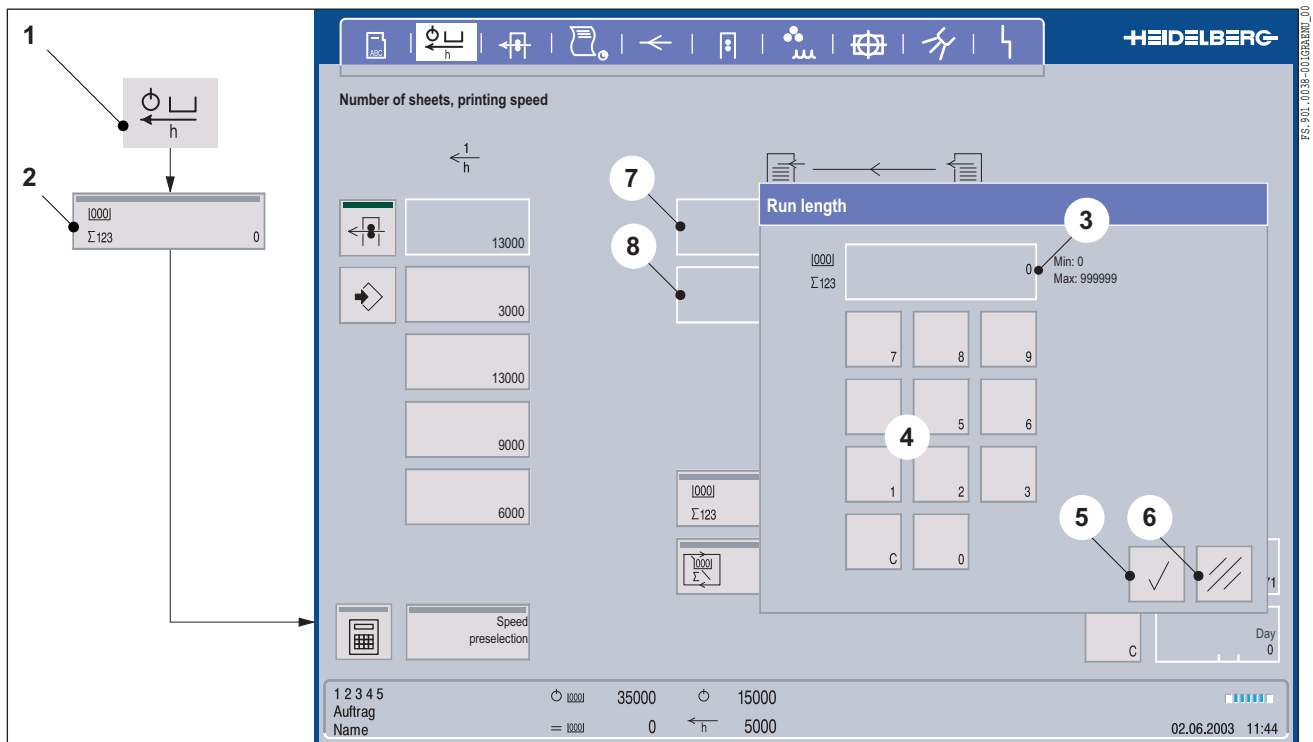

Fig. 2 Run length window

The **Number of sheets, printing speed** menu enables you to select the desired number of sheets for the current print job.

1. Press the *Number of sheets, printing speed* button (Fig. 2/1) in the headline. The **Number of sheets, printing speed** menu appears.
2. Press the *Desired number of sheets* button (Fig. 2/2). The **Number of impressions** window (Fig. 2) appears.
3. Enter the desired number of sheets using the numeric keypad (Fig. 2/4). The value appears in the display panel (Fig. 2/3). If you confirm your entry, the job counter (Fig. 2/7) and the waste-sheet counter (Fig. 2/8) are reset to 0.
4. Confirm the input: Press the *OK* button (Fig. 2/5).
or
Abort the process: Press the *Delete* push button (Fig. 2/6).

1.3 Changing the desired quantity of sheets

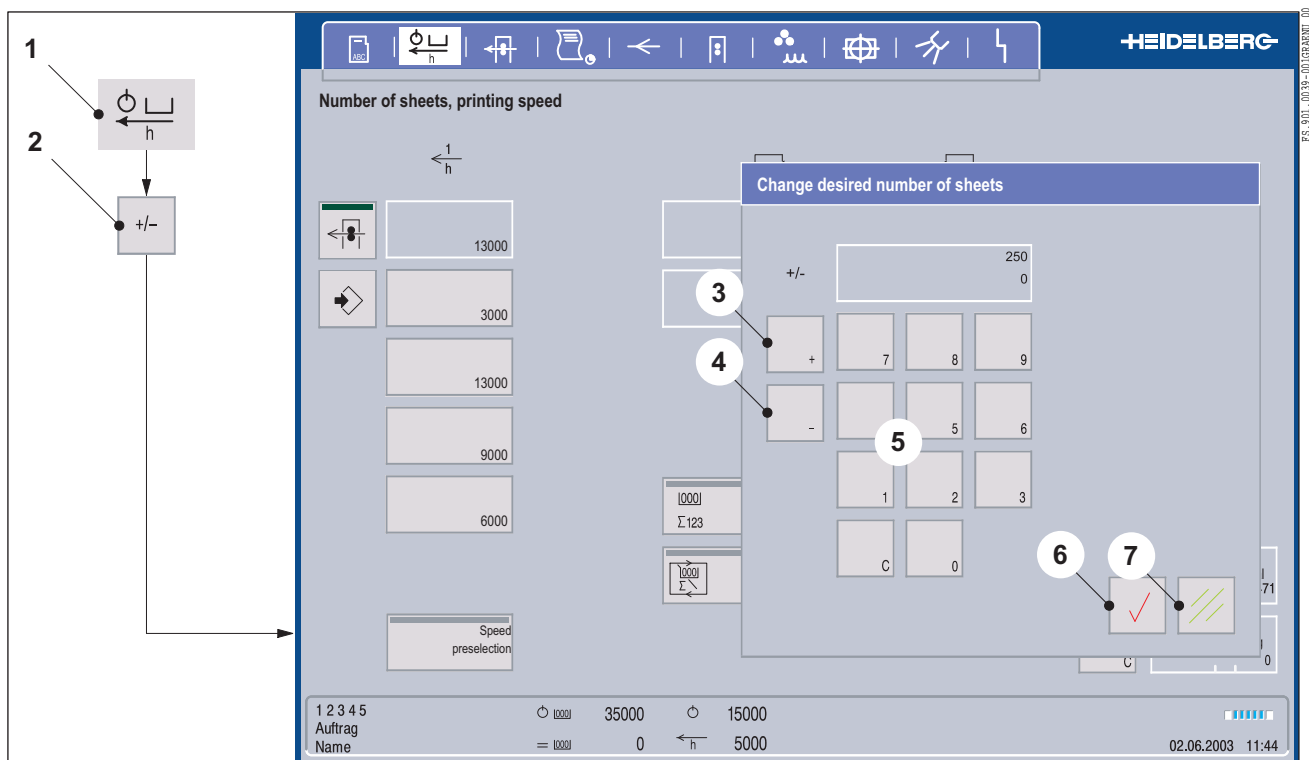

Fig. 3 Number of sheets/change desired number of sheets window

You can change the desired number of sheets during a print job. If you later wish to increase or decrease the desired number of sheets, proceed as follows:

1. Use the *+/-* button (Fig. 3/2) to increase or decrease the desired number of sheets. The **Number of sheets/Change desired number of sheets** menu appears.
2. To increase desired number of sheets: Press the *+* button (Fig. 3/3) and use the numeric keypad

(Fig. 3/5) to enter the value by which you wish to increase the desired number of sheets.

or

To reduce the desired number of sheets: Press the - button (Fig. 3/4) and use the numeric keypad (Fig. 3/5) to enter the value by which you wish to reduce the desired number of sheets.

3. To confirm your entry: Press the *OK* button (Fig. 2/6).

or

To cancel the operation: Touch the button *Delete* (Fig. 2/7).

► Note

If you press the *Desired number of sheets* button (Fig. 3/2) and alter the desired number of sheets, the job counter and the waste-sheet counter are **not** reset to 0.

1.4 Setting the job counter

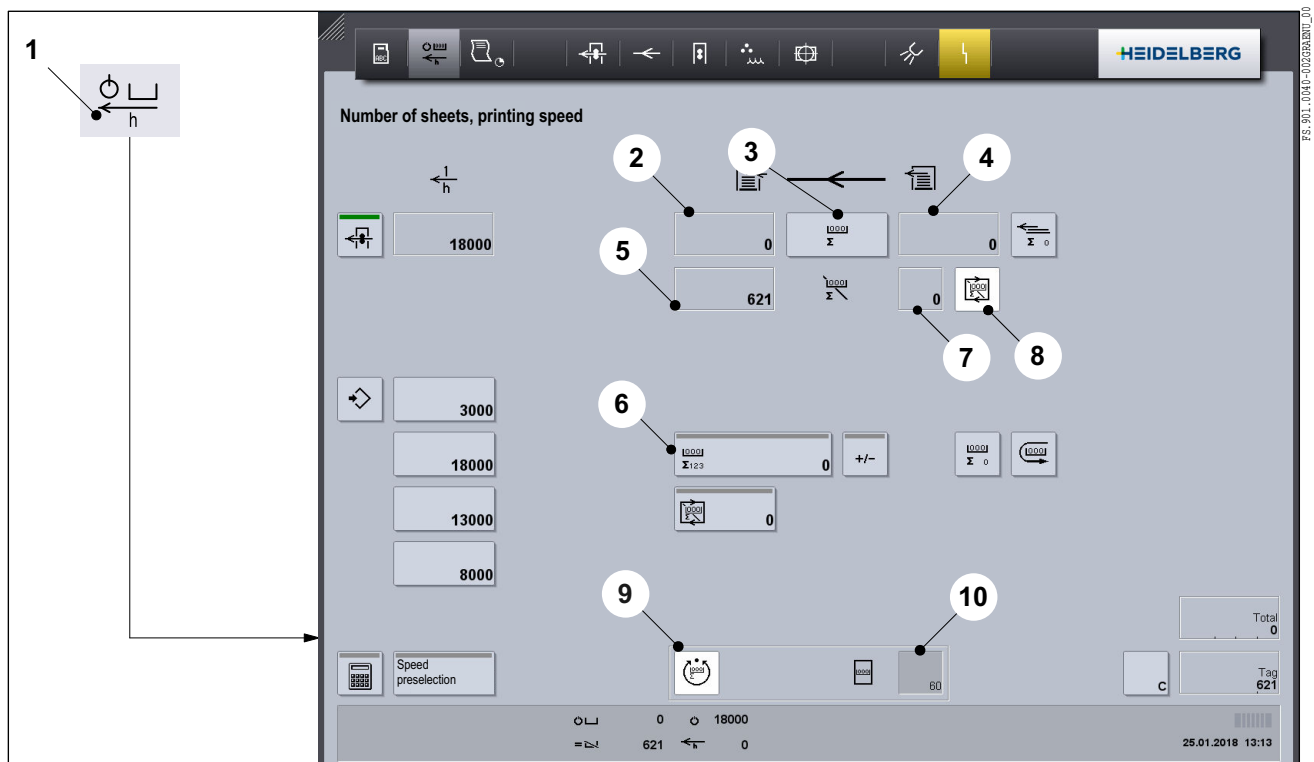

Fig. 4 Number of sheets, printing speed menu

In the **Number of sheets, printing speed** menu (Fig. 4) you can set the job counter and the waste-sheet counter for the current print job.

1. Press the *Desired number of sheets* button (Fig. 4/6). The **Number of sheets/Number of impressions** window (Fig. 2) appears.
2. Use the numeric keypad (Fig. 2/4) to enter the desired number of sheets. The value appears in

the display panel (Fig. 2/3). If you confirm your entry, the job counter (Fig. 4/2) and the waste-sheet counter (Fig. 4/5) are reset to 0.

3. Switch the job counter (Fig. 4/3) off. Printed sheets are counted on the waste-sheet counter (Fig. 4/5). If the makeready interval counter (Fig. 4/8) is switched on, the printed sheets are deducted from the "makeready interval for the residual number of impressions" (Fig. 4/7).
4. As soon as you are no longer producing any more waste sheets, switch the job counter (Fig. 4/3) on. The waste-sheet counter (Fig. 4/5) stops counting. The printed sheet are counted by the job counter (Fig. 4/2).

During the actual printing process, the job counter can be switched on and off at any time. If the job counter is switched off, the sheets are counted on the waste-sheet counter. If the job counter is switched on, the sheets are counted on the job counter.

At the end of a print job you then have the precise number of good sheets and waste copies at your disposal.

Starting the good-sheet counter automatically

If the function is activated, the control system will automatically start the good-sheet/job counter once the set number of sheets has been reached.

1. Press the counter value (Fig. 4/10).
2. Enter the desired number of sheets and confirm with the *OK* button.
3. Activate the function "Start good-sheet counter automatically" (Fig. 4/9).

1.5 Setting the makeready interval

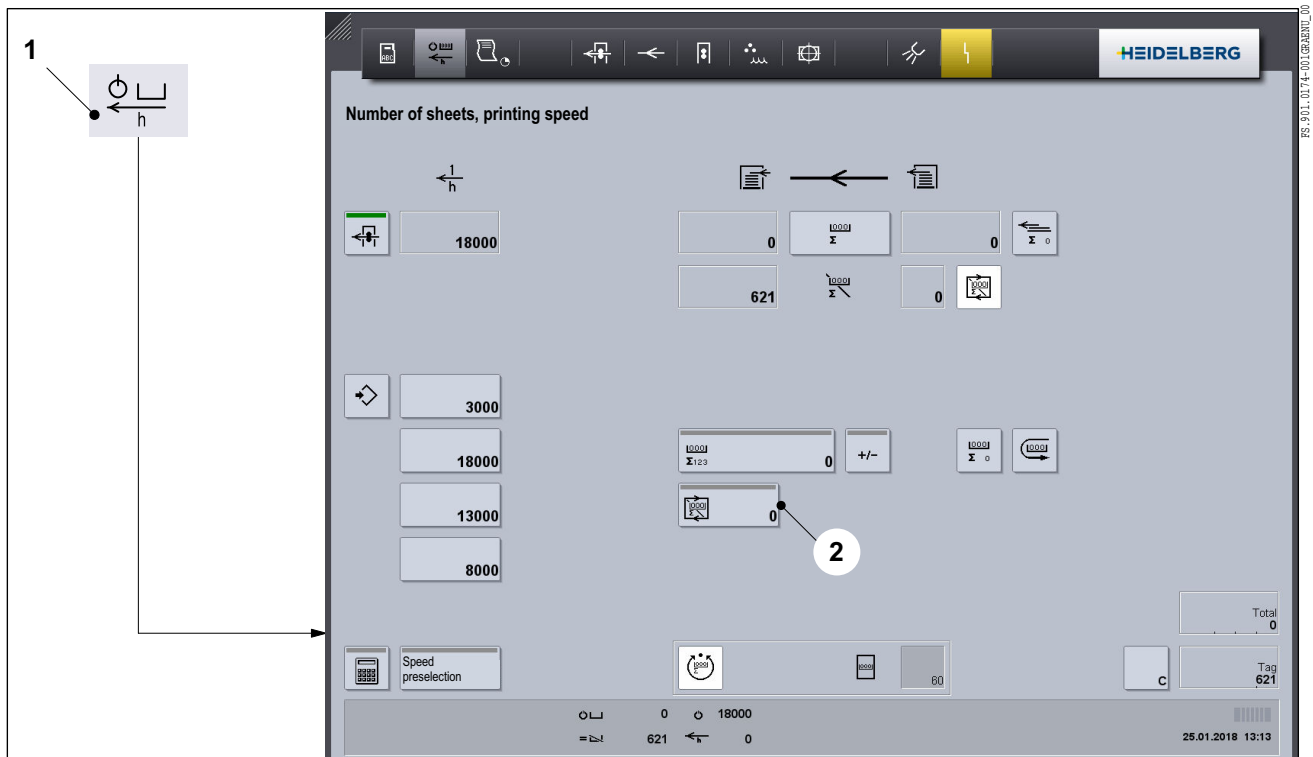

Fig. 5 Number of sheets/makeready interval window

The **Number of sheets, printing speed** menu enables you to set the makeready interval for the current print job.

1. Press the *Enter makeready interval* button (Fig. 5/2). The **Number of sheets/Makeready interval** window appears.
2. Use the numeric keypad to enter the required number of waste copies. The value appears in the display panel. When you confirm the entry, the value is copied to the *Makeready interval for the residual number of impressions* button.
3. To confirm the entry, press the *OK* button.

or

To abort the procedure: Press the *Delete* button.



Tip

Use the makeready interval counter for setting up a new job to count a fixed number of sheets as waste.



Note

The feeder is switched off when the makeready interval is reached. You can set the makeready interval counter to a maximum of 999 sheets.

1.6 Emptying the pile after a print job

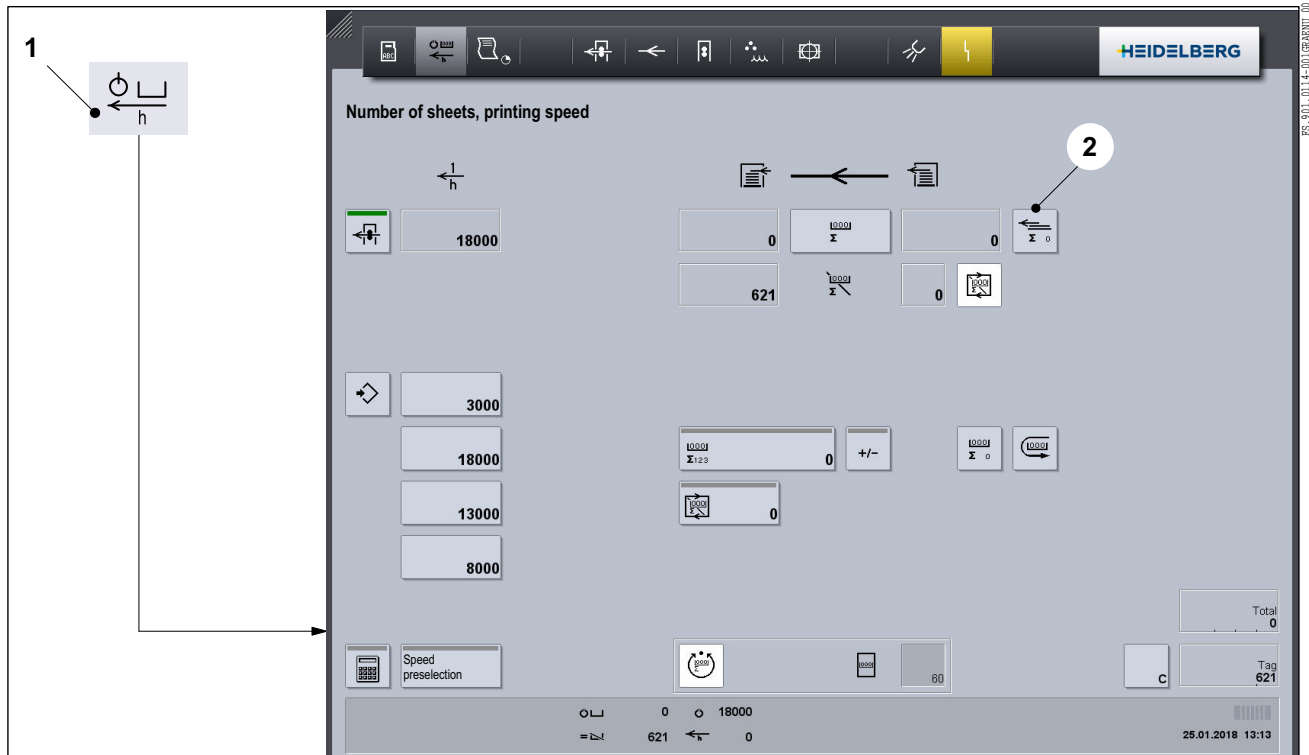

Fig. 6 Number of sheets, printing speed menu

On the **Quantity, printing speed** menu you can set that you wish the pile in the feeder to be emptied once the print job is complete. The sheets that are printed after the end of a print job are counted as good sheets.

1. Press the *Number of sheets, printing speed* button (Fig. 6/1) in the headline. The **Number of sheets, printing speed** menu appears.
2. Press the *Empty pile* button (Fig. 6/2). When the button has a light background, the machine continues to print after the desired number of sheets has been reached until the pile is empty.

► Note

The *Emptying the pile* function must be activated again for each print job. The function is automatically deselected as soon as you restart the press, accept a job, enter a new desired number of sheets or change the desired number of sheets with the +/- buttons.